

START HERE! READ ME FIRST

Don't be a hero and muscle through this installation without reading these fitting instructions first! Improper installation of this gear may void certain aspects of your warranty.

Before you begin, take a moment and open all your Front Runner rack kit boxes and gather the assembly instructions for the various components.

A complete kit will contain:

1. A Front Runner Mounting System specific to your vehicle
2. A Front Runner Rack Tray or Load Bar Slats

This document will guide you through the assembly of the mounting system and assist you in fitting the roof rack tray or load bars to your specific vehicle.

Please refer to the next page for a list of all the components, quantities and tools required.

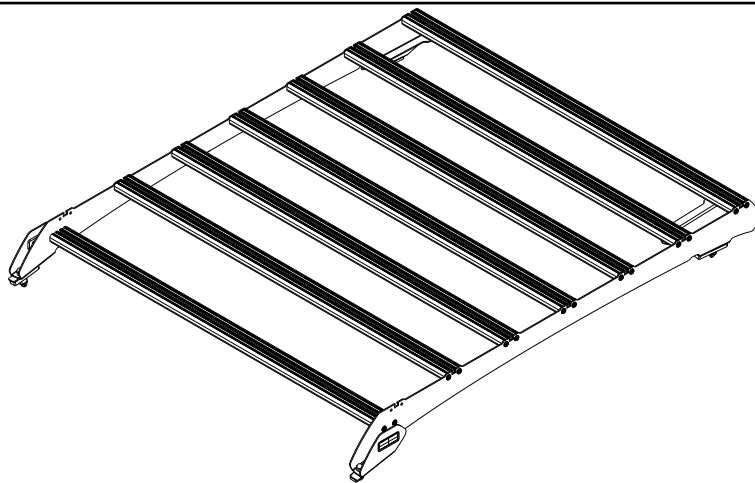

IMPORTANT WARNING!

IT IS CRITICAL THAT ALL FRONT RUNNER PRODUCTS BE PROPERLY AND SECURELY ASSEMBLED AND ATTACHED TO YOUR VEHICLE. IMPROPER ATTACHMENT COULD RESULT IN AN AUTOMOBILE ACCIDENT, AND COULD CAUSE SERIOUS BODILY INJURY OR DEATH. YOU ARE RESPONSIBLE FOR ASSEMBLING AND SECURING ALL FRONT RUNNER PRODUCTS TO YOUR VEHICLE, CHECKING THE ATTACHMENTS PRIOR TO USE, AND PERIODICALLY INSPECTING THE PRODUCTS FOR ADJUSTMENT, WEAR AND DAMAGE. THEREFORE, YOU MUST READ AND UNDERSTAND ALL OF THE INSTRUCTIONS AND PRECAUTIONS SUPPLIED WITH YOUR FRONT RUNNER PRODUCT PRIOR TO INSTALLATION OR USE. IF YOU DO NOT UNDERSTAND ALL OF THE INSTRUCTIONS AND CAUTIONS, OR IF YOU HAVE NO MECHANICAL EXPERIENCE AND ARE NOT THOROUGHLY FAMILIAR WITH THE INSTALLATION PROCEDURES, YOU SHOULD HAVE THE PRODUCT INSTALLED BY A PROFESSIONAL INSTALLER OR OTHER QUALIFIED PERSONNEL.

NOTE: Front Runner will not be responsible for any damage caused by the failure to install the product according to these instructions.

Please call us if you have any questions about the installation of this product.



1 GET ORGANIZED - FOR USA SPEC FITMENT ONLY

IN THE BOX

1	2 X	Foot Rail 1LH + 1RH
2	2 X	Wing Plate 1 LH + 1 RH
3	7 X	SlimSport Slat (1170mm Long)
4	2 X	Front Spacer - 10mm
6	2 X	Rear Spacer - 10mm
8	28 X	M6 x 20 Button Head Bolt
9	4 X	M6 x 45 Hex Bolt
10	8 X	M6 x 20 x 2 flat Washer
11	8 X	M6 Nyloc Nut
12	8 X	M6 Nut Cap
13	2 X	Stiffener Bracket LH + RH
14	4 X	M8 x 20 Hex Bolt
15	4 X	M8 x 16 x 1.6 Flat Washer
16	4 X	M8 Nyloc Nut
17	4 X	M8 Nut Cap

TOOLS NEEDED

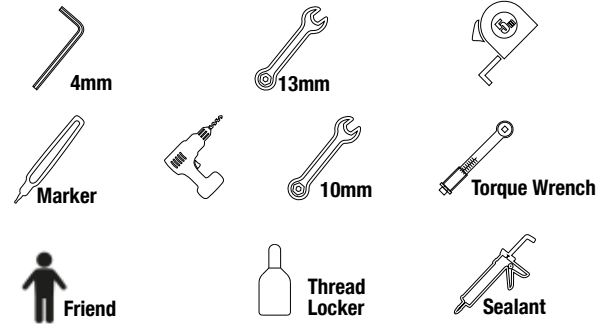
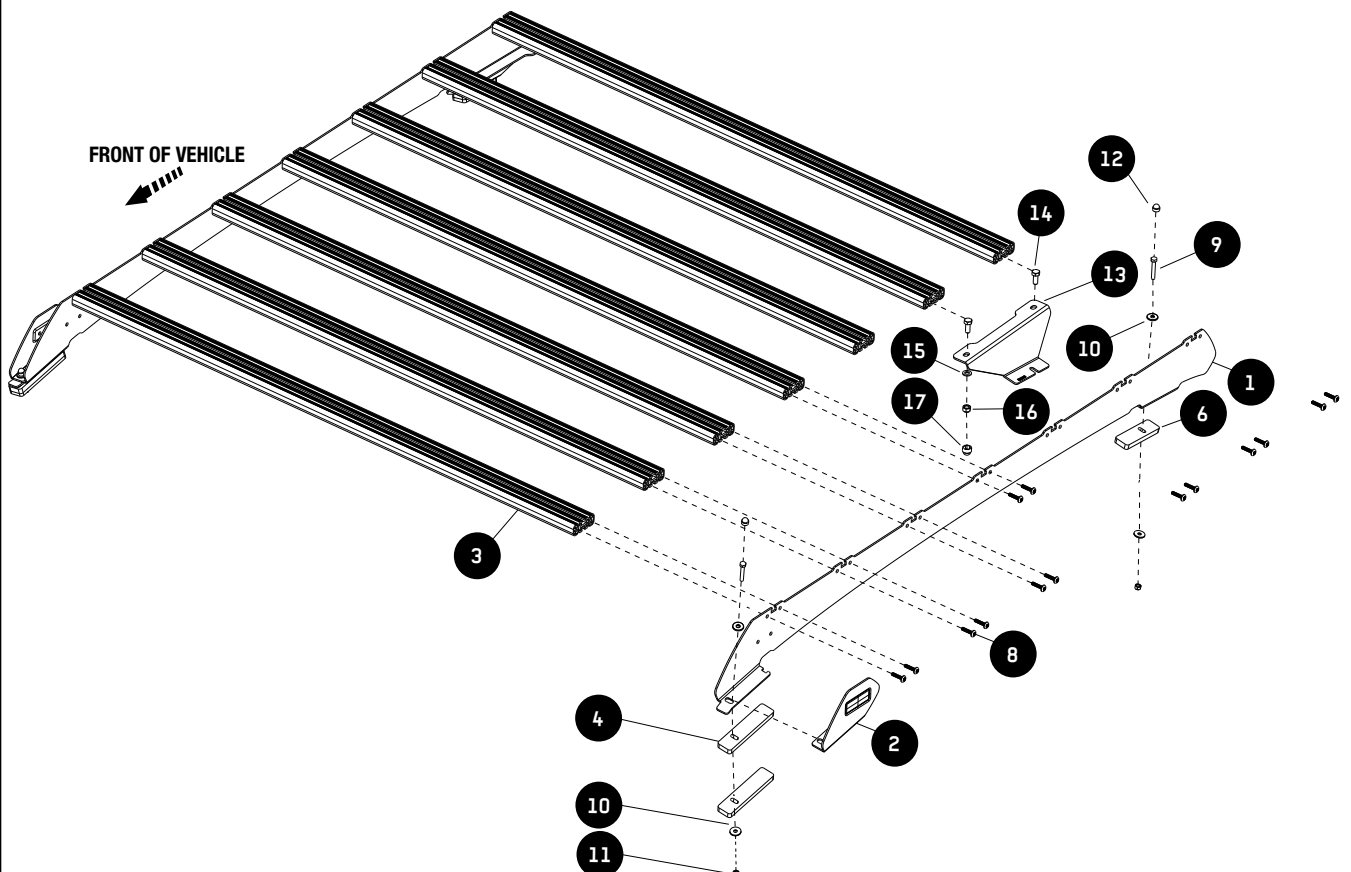

FIGURE 1.1

FOR USA SPEC FITMENT ONLY



2

FIT AND SECURE - FOR USA SPEC FITMENT ONLY

2.1



Drop the vehicle's roof lining.



Look online for videos to assist.

2.2



After the Roof Lining is doped, Loosen the M6 nuts on the inside of the Roof holding the Ditch trim in place and remove the Ditch trim from the Roof.

2.3

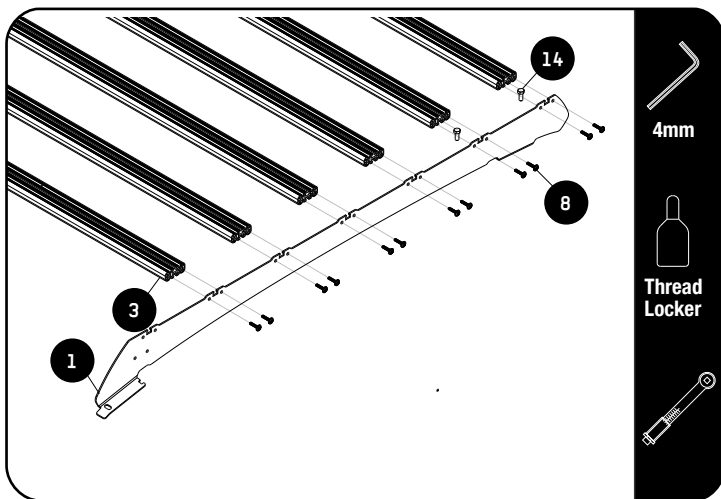

NOTE: Do not fit the front slats yet.



Apply a drop of Thread Locker on each M6 x 20 Button Head bolt before securing the slats.



Before assembling the Foot Rails to the slats slide the two M8 x 20 Hex Bolts (Item 14) into the first and second slat from the rear as shown. This will be used to secure the support Bracket in 2.4.

Assemble six Slats (Item 3) to the Foot Rails using M6 x 20 Button Head Bolts (Item 8).



Tightening Torque 8-10Nm / 5.9 ft lb - 7.38 ft lb. Take care when using a cordless driver.

2**FIT AND SECURE - FOR USA SPEC FITMENT ONLY**

2.4

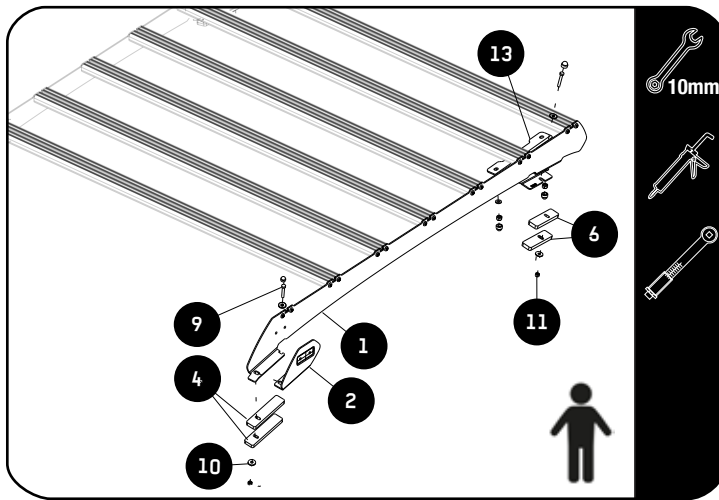

Apply a bead of sealant on the threads of the M6 x 45 Hex Bolts.

At the rear loosely secure the Foot Rail (Item 1) together with the Support Bracket (Item 13) and the Rear Spacers (Item 6) to the Roof using the M6 x 45 Hex Head Bolts, M6 x 20 x 2 Flat Washers and M6 Nyloc Nuts (Items 9, 10 & 11).

At the front loosely secure the Tray together with Front Spacers (Item 4) and the Wing Plates (Item 2) to the Roof using M6 x 45 Hex Bolts, M6 x 20 x 2 Flat Washers and M6 Nyloc Nuts (Items 9, 10 & 11).

Secure the Support Brackets to the bottom of the slats using M8 x 16 x 1.6 Flat washer and M8 Nyloc nuts (Item 15 & 17).



Proceed to the Wind fairing fitment guide.

All the fasteners will be fully tightened after the Wind Fairing is secured in place.



1 GET ORGANIZED

IN THE BOX

1	2 X	Foot Rail 1LH + 1RH
2	2 X	Wing Plate 1 LH + 1 RH
3	7 X	SlimSport Slat (1170mm Long)
4	2 X	Front Spacer - 10mm
5	2 X	Rear Spacer - 10mm
6	8 X	Bottom Spacer (Non Wildtrak versions)
7	28 X	M6 x 20 Button Head Bolt
8	4 X	M8 x 45 Hex Bolt
9	4 X	M8 x 19 x 2 Flat Washer
10	8 X	M8 Nyloc Nut
11	8 X	M8 Nut Cap
12	8 X	M8 x 16 x 1.6 Flat Washer
13	1 X	Stiffener Bracket LH
14	1 X	Stiffener Bracket RH
15	4 X	M8 x 20 Hex Bolt

TOOLS NEEDED

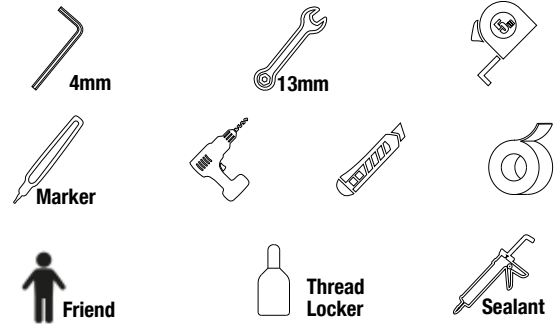
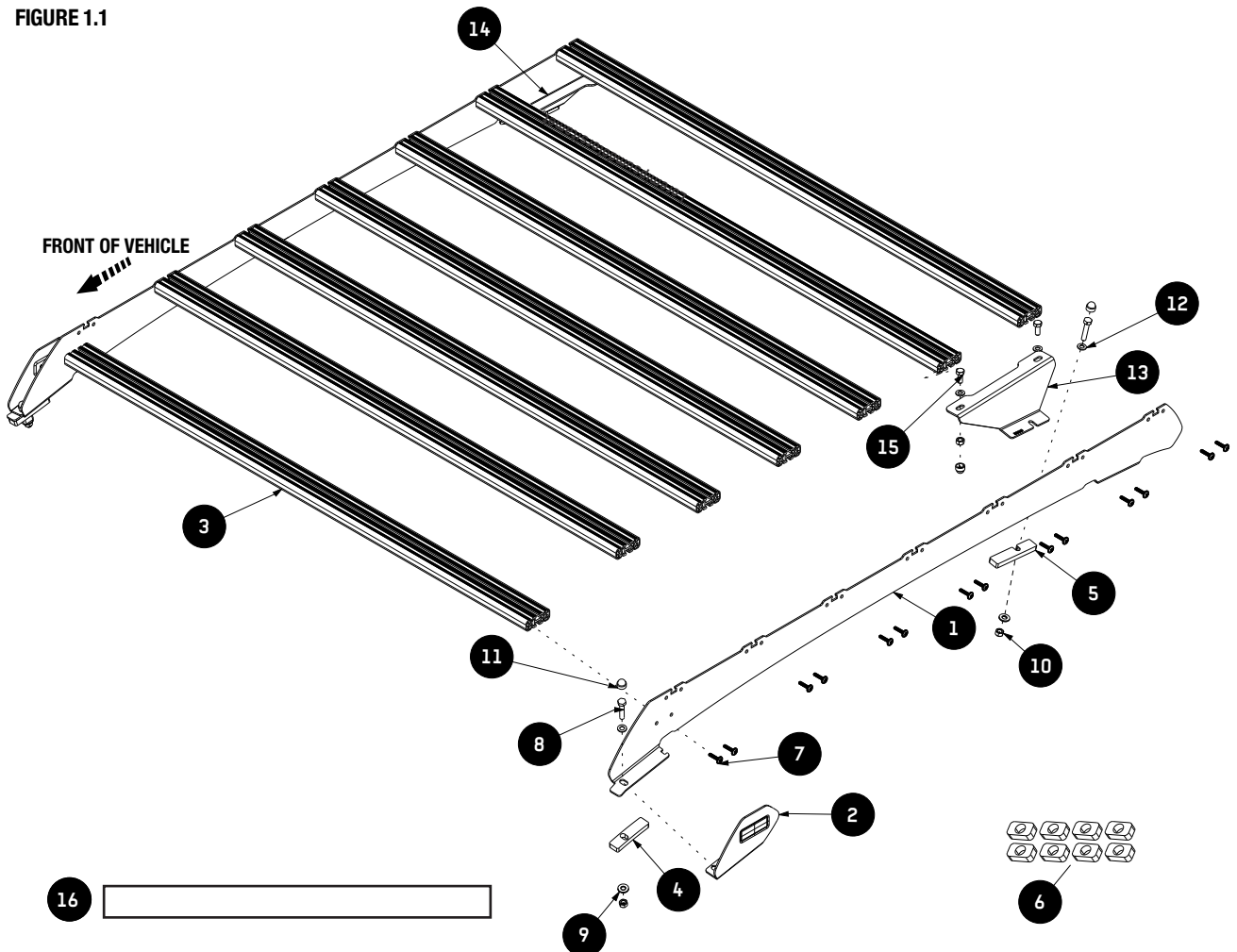

FIGURE 1.1



2

FIT AND SECURE - MODELS WITHOUT FACTORY ROOF RAILS

2.1



Drop the vehicle's roof lining.



Look online for videos to assist.

2.2

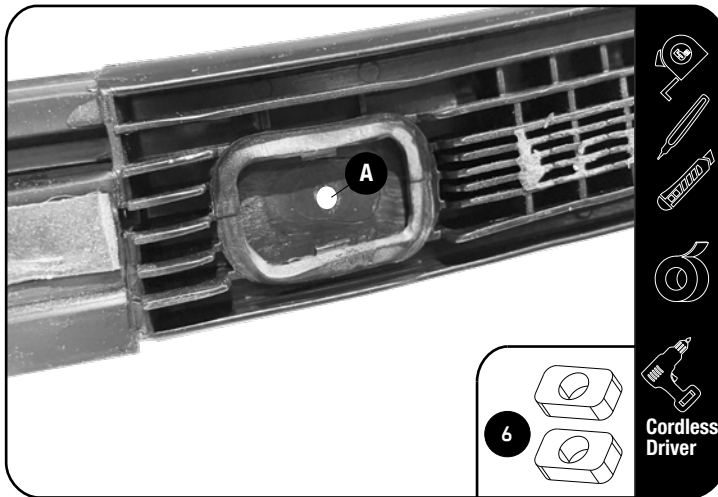

Peel back the weather strip enough so that you can remove the weather strip retaining bolt, remove the front and rear stud insert from the plastic trim.

Place the Bottom Spacer (Item 6) into the opening where the stud inserts was removed and mark the center of the hole (A).

Drill a 6mm Pilot hole and open it to a 8.5mm Hole.

Remove the original double sided tape and clean the ditch.

Cut the supplied Double Sided Tape (Item 16) into four equal paces and adhere in it the ditch at equal spacing where the original double sided tape was removed.

Refit the Ditch Trim with two Bottom Spacers (Item 6) per mounting point, between the ditch trim and the vehicle's roof.

2.3

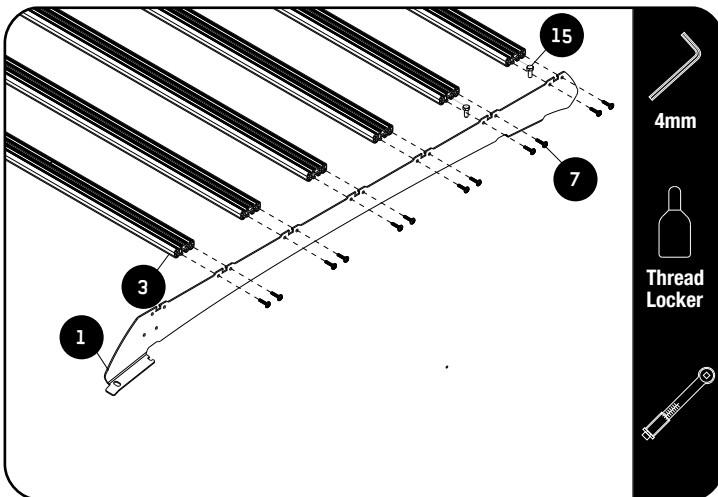

NOTE: Do not fit the front slats yet.



Apply a drop of Thread Locker on each M6 x 20 Button Head bolt before securing the slats.



Before assembling the Foot Rails to the slats slide the two M8 x 20 Hex Bolts (Item 15) into the first and second slat from the rear as shown. This will be used to secure the support Bracket in 2.4.

Assemble six Slats (Item 3) to the Foot Rails using M6 x 20 Button Head Bolts (Item 8).



Tightening Torque 8-10Nm / 5.9 ft lb - 7.38 ft lb. Take care when using a cordless driver.

2

FIT AND SECURE - MODELS WITHOUT FACTORY ROOF RAILS

2.4

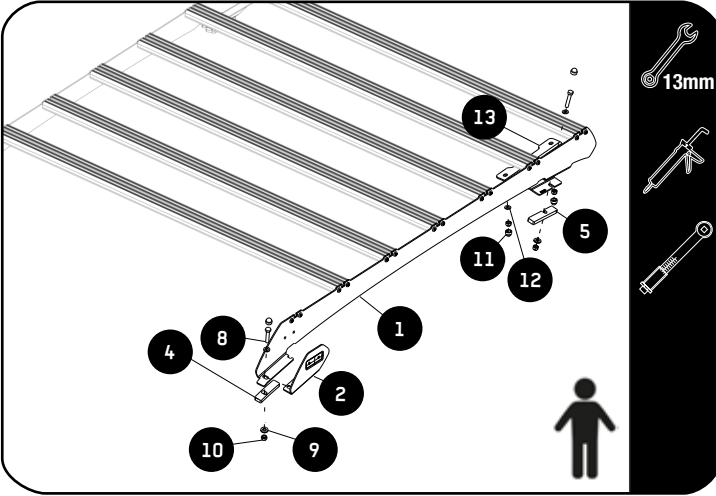

Apply a bead of sealant on the threads of the M6 x 45 Hex Bolts.

At the rear loosely secure the Foot Rail (Item 1) together with the Support Bracket (Item 13) and the Rear Spacers (Item 5) to the Roof using the M6 x 45 Hex Head Bolts, M x 19 2 Flat Washers and M Nylon Nuts (Items 8,9 & 10).

At the front loosely secure the Tray together with Front Spacers (Item 4) and the Wing Plates (Item 2) to the Roof using M x 45 Hex Bolts, M x 19 2 Flat Washers and M Nylon Nuts (Items 8, 9 & 10).

Secure the Support Brackets to the bottom of the slats using M x 16 1.6 Flat washer and M8 Nylon nuts (Item 15 & 17).



Proceed to the Wind fairing fitment guide.
All the fasteners will be fully tightened after the Wind Fairing is secured in place.

FIT AND SECURE - MODELS WITH FACTORY ROOF RAILS

3.1



Drop the vehicle's roof lining.



Look online for videos to assist.

3.2



Remove the OEM Rails with Ditch Trim from the vehicles roof by unbolting the nut on the inside of the roof.
Remove the EOM rails from the Ditch Trim.

3.3



Place a bead of Sealant on the Ditch Trim before placing it back into the vehicles ditch.
In 3.5 you will use the supplied hardware to secure the Foot Rail/Tray onto the Ditch Trim.

3.4

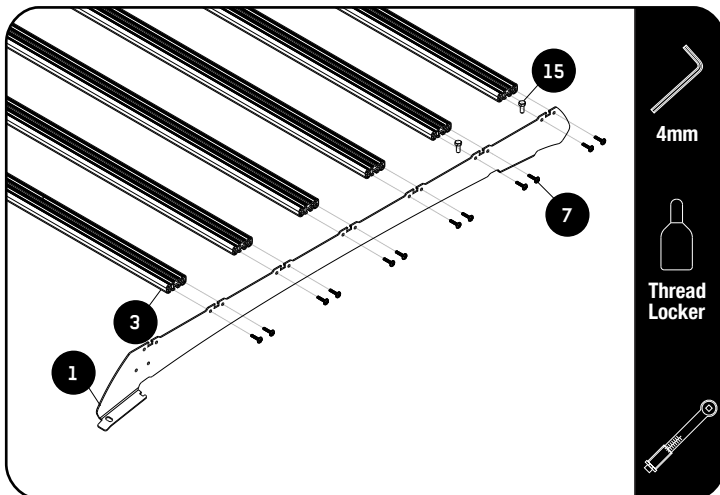

NOTE: Do not fit the front slats yet.

Apply a drop of Thread Locker on each M6 x 20 Button Head bolt before securing the slats.

Before assembling the Foot Rails to the slats slide the two M8 x 20 Hex Bolts (Item 15) into the first and second slat from the rear as shown. This will be used to secure the support Bracket in 2.4.

Assemble six Slats (Item 3) to the Foot Rails using M6 x 20 Button Head Bolts (Item 8).

Tightening Torque 8-10Nm / 5.9 ft lb - 7.38 ft lb. Take care when using a cordless driver.

3

FIT AND SECURE - MODELS WITH FACTORY ROOF RAILS

3.5

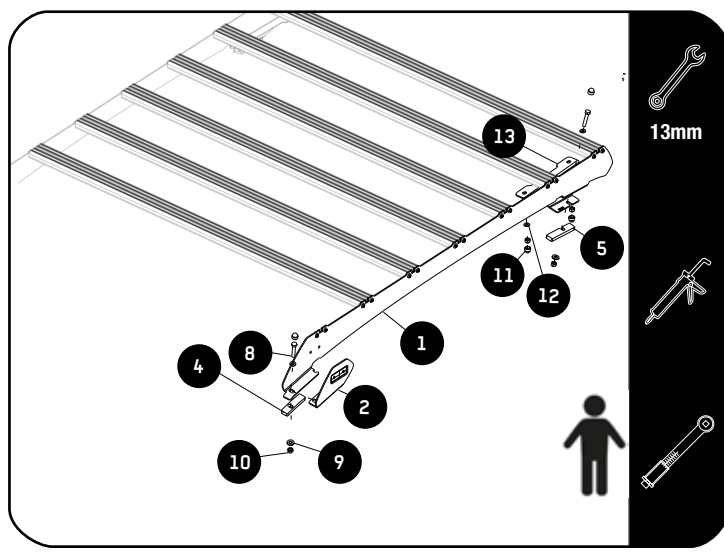

Apply a bead of sealant on the threads of the M x 45 Hex Bolts.

At the rear loosely secure the Foot Rail (Item 1) together with the Support Bracket (Item 13) and the Rear Spacers (Item 5) to the Roof using the M x 45 Hex Head Bolts, M x 19 2 Flat Washers and M Nylon Nuts (Items 8,9 & 10).

At the front loosely secure the Tray together with Front Spacers (Item 4) and the Wing Plates (Item 2) to the Roof using M x 45 Hex Bolts, M x 19 2 Flat Washers and M Nylon Nuts (Items 8, 9 & 10).

Secure the Support Brackets to the bottom of the slats using M x 16 1.6 Flat washer and M Nylon nuts (Item 15 & 17).

Proceed to the Wind fairing fitment guide.
All the fasteners will be fully tightened after the Wind Fairing is secured in place.

4

FIT AND SECURE

STANDARD WIND FAIRING ASSEMBLY

4.1

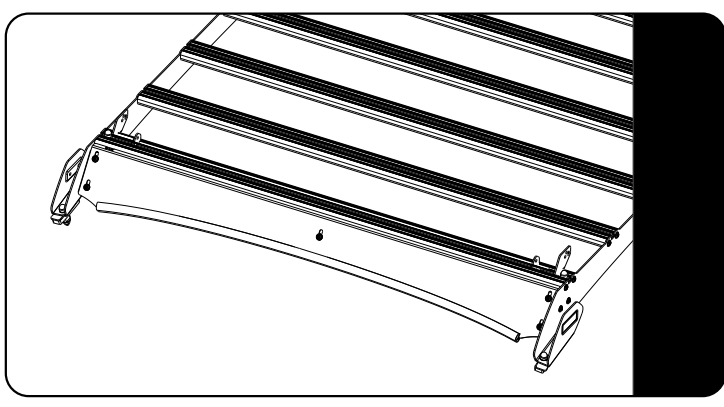

Refer to fitment guide RRAC378

LIGHT BAR WIND FAIRING ASSEMBLY

4.2

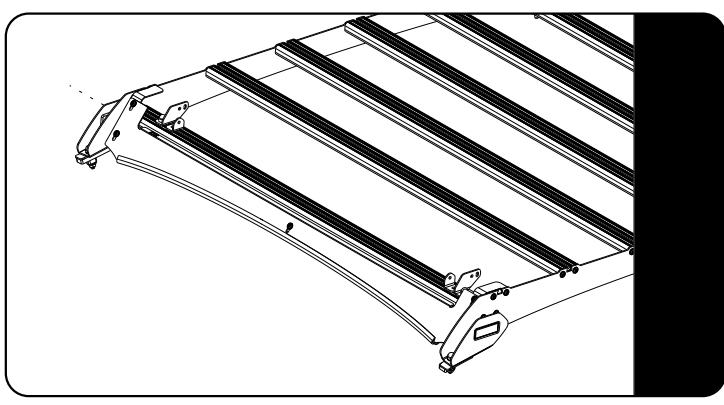

Refer to fitment guide RRAC377

5

COMPLETION

5.1

Congratulations! You did it. Take a step back and admire your work!



6

INSTALL OTHER VEHICLE AND RACK ACCESSORIES

Now's the time to visit your favorite Front Runner dealer in person or online.

IMPORTANT!

FRONT RUNNER RACK KITS OFTEN HAVE A HIGHER LOAD RATING THAN THE VEHICLES THEY ARE MOUNTED TO. PLEASE REFER TO YOUR SPECIFIC VEHICLE MANUFACTURER FOR A RECOMMENDED ROOF RATING. FRONT RUNNER CANNOT BE RESPONSIBLE FOR IMPROPER LOADING BEYOND THE VEHICLE MANUFACTURER'S STATED LOAD CAPACITY.

Be sure to tag us. We love to see our gear in action! #FrontRunnerOutfitters #BornToRoam

Share your adventures on: 